



FOR LEASE - ±7,761 SF INDUSTRIAL UNIT

3944-3946 W. SEGERSTROM AVENUE | SANTA ANA, CA



PROPERTY FEATURES:

- » Nice Image Multi-Tenant Industrial Building
- » End Cap Unit
- » ±2,200 SF of Office Space
- » Segerstrom Avenue Frontage
- » Two (2) Ground Level Loading Door
- » 200 Amps Power (verify)
- » ±18' Warehouse Clear Height
- » Thirteen (13) Parking Spaces
- » Good San Diego (405) Freeway Access
- » Fenced Yard Possible

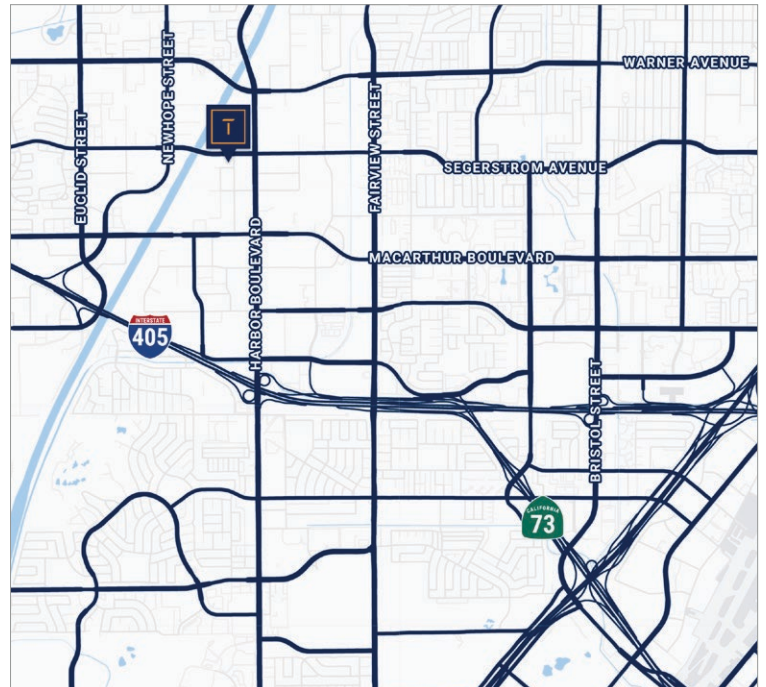

CONTACT US:

TAYLOR SNYDER, MBA
SENIOR VICE PRESIDENT

(949) 533-1321
taylor@tidemarkrealestate.com
DRE Lic. 02092420

JIM SNYDER, CCIM, CPM®
CHIEF EXECUTIVE OFFICER

(949) 533-1190
jim@tidemarkrealestate.com
DRE Lic. 00872220

PAT LACEY
EXECUTIVE DIRECTOR

(714) 875-4134
pat@tidemarkrealestate.com
DRE Lic. 00988663

WILL GREUBEL
SENIOR VICE PRESIDENT

(714) 614-7623
will@tidemarkrealestate.com
DRE 02039807

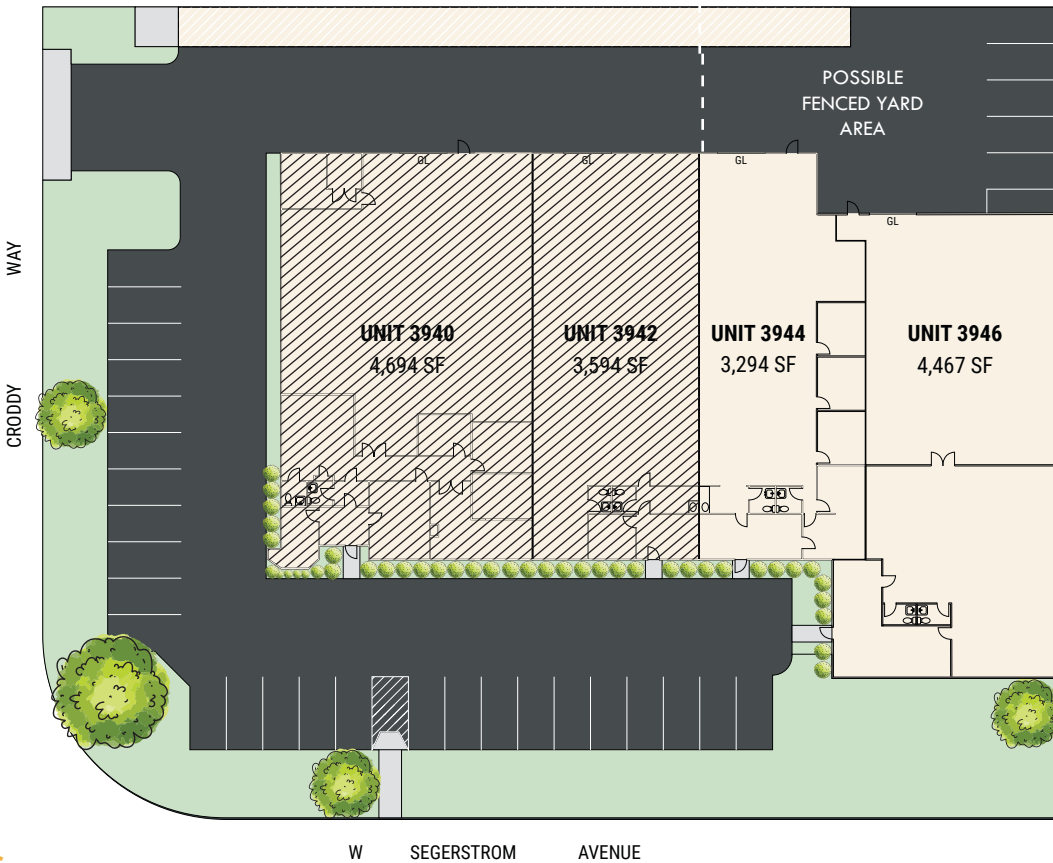

CONTACT US:

TAYLOR SNYDER, MBA
SENIOR VICE PRESIDENT

(949) 533-1321
taylor@tidemarkrealestate.com
DRE Lic. 02092420

JIM SNYDER, CCIM, CPM®
CEO

(949) 533-1190
jim@tidemarkrealestate.com
DRE Lic. 00872220

PAT LACEY
EXECUTIVE DIRECTOR

(714) 875-4134
pat@tidemarkrealestate.com
DRE Lic. 00988663

WILL GREUBEL
SENIOR VICE PRESIDENT

(714) 614-7623
will@tidemarkrealestate.com
DRE 02039807