



FOR LEASE - ±5,318 SF

17443 MOUNT CLIFFWOOD CIRCLE | FOUNTAIN VALLEY, CA



PROPERTY FEATURES:

- » ±600 SF of Office Space
- » Renovated Office Area and Windows
- » 16' Clear Height
- » One (1) Ground Level Loading Door
- » Fire Sprinklers
- » 10 Parking Spaces
- » Shared Secure Exterior Parking/Storage Area
- » Minutes from Costco and Other Retail Amenities
- » Great San Diego (405) Freeway Access

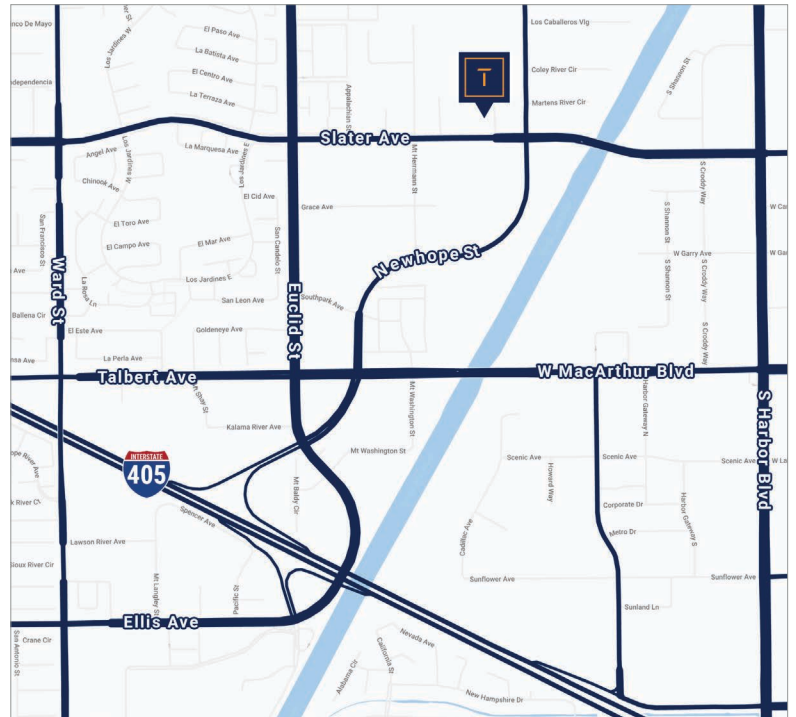

CONTACT US:

TIDEMARK
Real Estate Services
BROKERAGE | INVESTMENTS
PROPERTY MANAGEMENT

TAYLOR SNYDER, MBA
SENIOR VICE PRESIDENT
(949) 533-1321
taylor@tidemarkrealestate.com
DRE Lic. 02092420

PAT LACEY
EXECUTIVE DIRECTOR
(714) 875-4134
pat@tidemarkrealestate.com
DRE Lic. 00988663

WILL GREUBEL
VICE PRESIDENT
(714) 614-7623
will@tidemarkrealestate.com
DRE Lic. 02039807

DISCLAIMER: The information contained herein has been obtained from the property owner or other third party and is provided to you without verification as to accuracy. We (Tidemark Capital, Inc., its brokers, employees, agents, principals, officers, directors and affiliates) make no warranty or representation regarding the information, property, or transaction. You and your attorneys, advisors and consultants should conduct your own investigation of the property and transaction.

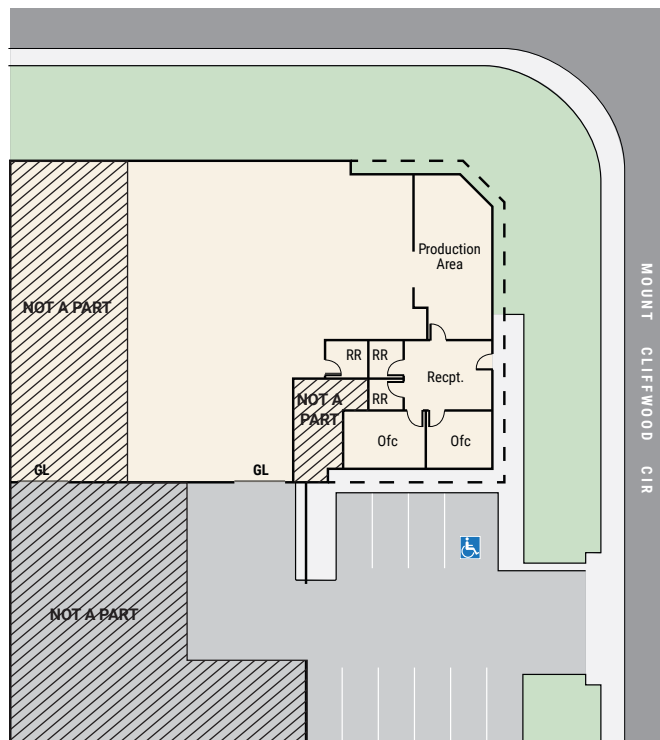

CONTACT US:

TIDEMARK
Real Estate Services
BROKERAGE | INVESTMENTS
PROPERTY MANAGEMENT

TAYLOR SNYDER, MBA
SENIOR VICE PRESIDENT
(949) 533-1321
taylor@tidemarkrealestate.com
DRE Lic. 02092420

PAT LACEY
EXECUTIVE DIRECTOR
(714) 875-4134
pat@tidemarkrealestate.com
DRE Lic. 00988663

WILL GREUBEL
VICE PRESIDENT
(714) 614-7623
will@tidemarkrealestate.com
DRE Lic. 02039807

DISCLAIMER: The information contained herein has been obtained from the property owner or other third party and is provided to you without verification as to accuracy. We (Tidemark Capital, Inc., its brokers, employees, agents, principals, officers, directors and affiliates) make no warranty or representation regarding the information, property, or transaction. You and your attorneys, advisors and consultants should conduct your own investigation of the property and transaction.