

FOR SALE – ±34,394 SF

TIDEMARK

Orange County, CA



4012 W GARRY AVENUE SANTA ANA, CA

PROPERTY FEATURES:

- ◆ ±34,394 SF Freestanding Industrial Building
- ◆ ±5,000 SF of Office Space
- ◆ Four (4) Ground Level Loading Doors
- ◆ Two (2) Interior Truckwells
- ◆ 18' Warehouse Clear Height
- ◆ 800 Amps of Power
- ◆ Fenced Loading/Parking Area
- ◆ Fire Sprinklers
- ◆ Divisible Building with Two (2) Separate Entries
- ◆ Located in Clauset Park Just off the San Diego (405) Freeway via Harbor Boulevard

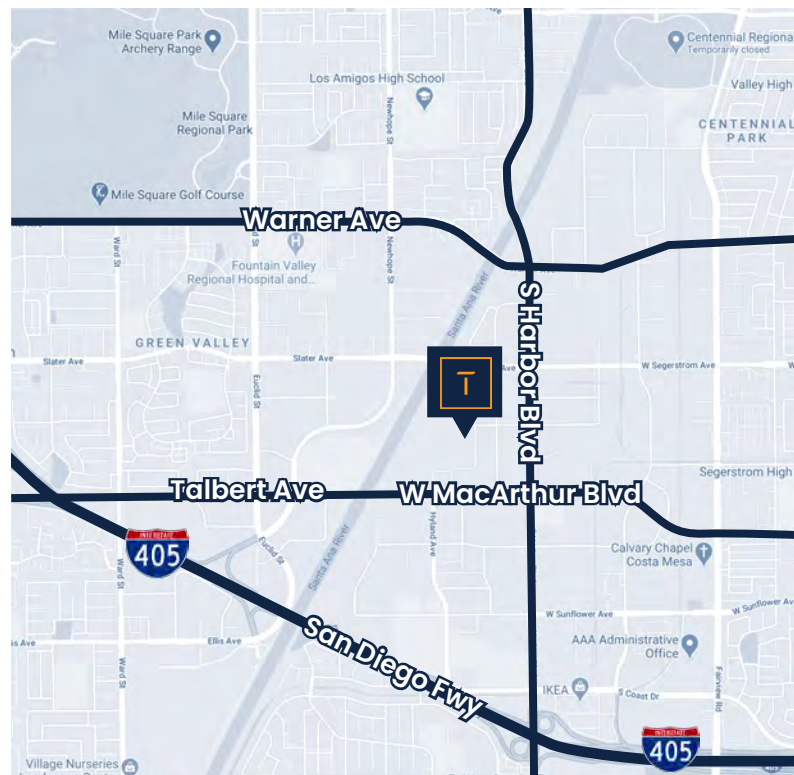

OFFERING PRICE: \$248 PSF

CONTACT US:

JIM SNYDER, CCIM, CPM®
SENIOR PARTNER
(949) 561-1900 ext. 3
jim@tidemarkrealestate.com
DRE 00872220

PAT LACEY
SENIOR PARTNER
(949) 561-1900 ext. 3
pat@tidemarkrealestate.com
DRE 00988663

WILL GREUBEL
SENIOR ASSOCIATE
(949) 561-1900 ext. 1
will@tidemarkrealestate.com
DRE 02039807



TIDEMARK
Real Estate Services

DISCLAIMER: The information contained herein has been obtained from the property owner or other third party and is provided to you without verification as to accuracy. We (Tidemark Capital, Inc., its brokers, employees, agents, principals, officers, directors and affiliates) make no warranty or representation regarding the information, property, or transaction. You and your attorneys, advisors and consultants should conduct your own investigation of the property and transaction.

FOR SALE - ± 34,394 SF

TIDEMARK

Orange County, CA

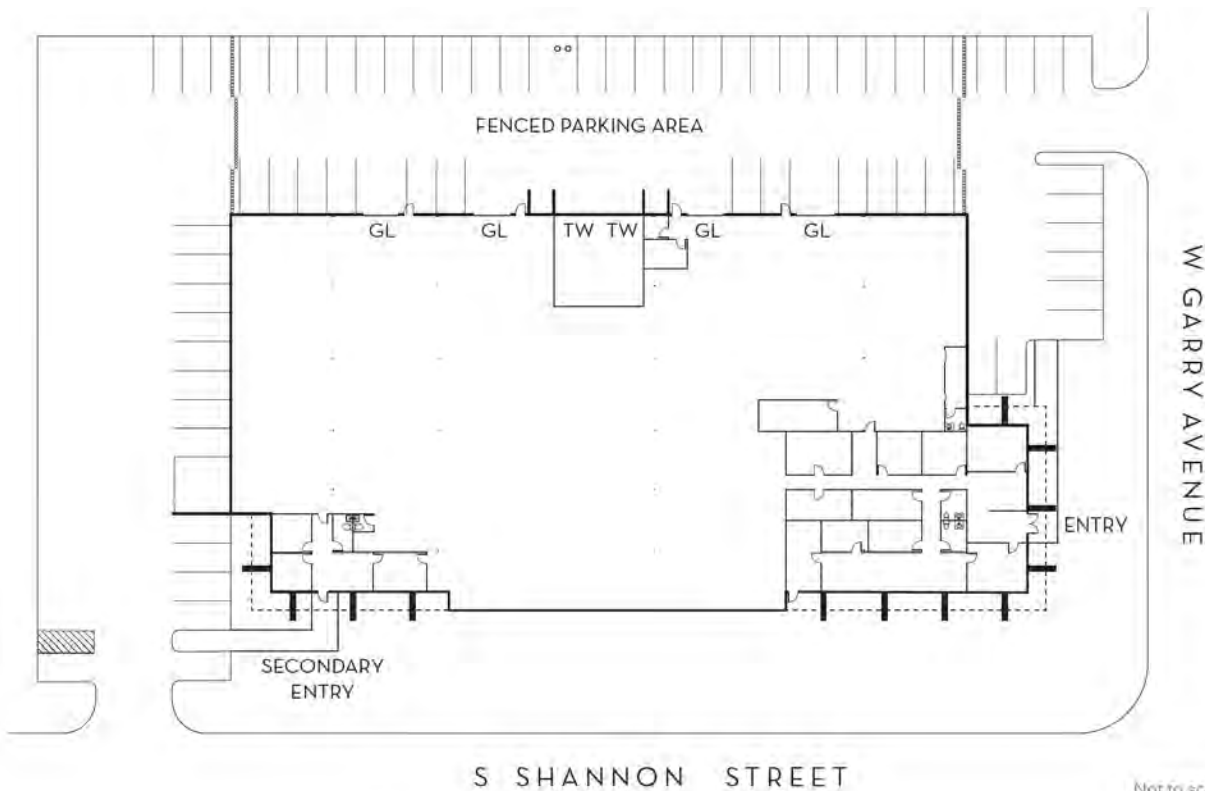
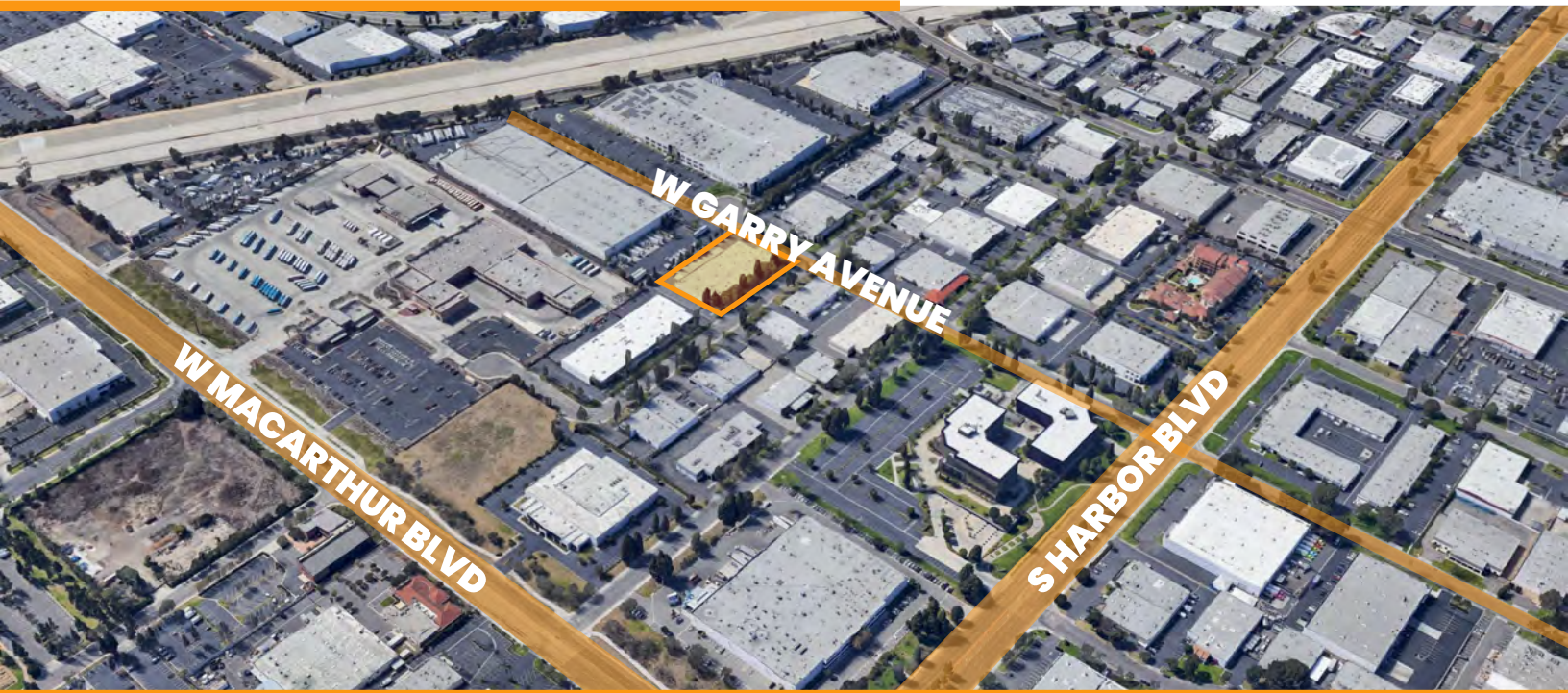

Not to scale. Not as built.

CONTACT US:

JIM SNYDER, CCIM, CPM®
SENIOR PARTNER
(949) 561-1900 ext. 3
jim@tidemarkrealestate.com
DRE 00872220

PAT LACEY
SENIOR PARTNER
(949) 561-1900 ext. 1
pat@tidemarkrealestate.com
DRE 00988663

WILL GREUBEL
SENIOR ASSOCIATE
(949) 561-1900 ext. 2
will@tidemarkrealestate.com
DRE 02039807



DISCLAIMER: The information contained herein has been obtained from the property owner or other third party and is provided to you without verification as to accuracy. We (Tidemark Capital, Inc., its brokers, employees, agents, principals, officers, directors and affiliates) make no warranty or representation regarding the information, property, or transaction. You and your attorneys, advisors and consultants should conduct your own investigation of the property and transaction.